



**Design Task Force #2**  
November 1, 2023



FOR UPDATES & UPCOMING  
MEETINGS ON THIS TOPIC:

Sign In Here



*Scan the QR Code with the camera  
on your smartphone, then follow  
the link to the sign-in sheet.*



Design Task Force 1 Sign In Sheet

Meeting Name	First	Last	Email	Date Signed Up
Bird Rock ES Whole Site Modernization	Angela	Volk	avolk@sandi.net	2023/10/18 7:16:41 PM MDT
Bird Rock ES Whole Site Modernization	Reggie	Constantino	rconstantini@sandi.net	2023/10/18 6:29:23 PM MDT
Bird Rock ES Whole Site Modernization	Jessica	Donovan	jessiejess847@gmail.com	2023/10/18 6:40:23 PM MDT
Bird Rock ES Whole Site Modernization	Mark	Di Tommaso	MarkTThomas@gmail.com	2023/10/18 6:42:53 PM MDT
Bird Rock ES Whole Site Modernization	Svetlana	Alleshouse	svetamg@gmail.com	2023/10/18 6:44:04 PM MDT
Bird Rock ES Whole Site Modernization	Mollie	McDonald	molliejeanmcdonald@gmail.com	2023/10/18 6:44:34 PM MDT
Bird Rock ES Whole Site Modernization	Asha	Bleier	asha.bleier@gmail.com	2023/10/18 6:44:36 PM MDT
Bird Rock ES Whole Site Modernization	Kristi	Benedetto	kristi@sparklefri.com	2023/10/18 7:36:46 PM MDT
Bird Rock ES Whole Site Modernization	Todd	Marchner	birdrockwaverlyavenue@gmail.com	2023/10/18 7:24:34 PM MDT
Bird Rock ES Whole Site Modernization	Harry	Bubbins	harrybubbins@gmail.com	2023/10/18 6:45:35 PM MDT
Bird Rock ES Whole Site Modernization	Harry	Bubbins	harrybubbins@gmail.com	2023/10/18 6:45:43 PM MDT
Bird Rock ES Whole Site Modernization	Ani	Gregory	ani.gregory@outlook.com	2023/10/24 1:10:35 PM MDT
Bird Rock ES Whole Site Modernization	David	Beck	dbeckjr@sandi.net	2023/10/18 6:29:33 PM MDT
Bird Rock ES Whole Site Modernization	Jeff	Hudson	jfhudson111@gmail.com	2023/10/18 6:40:16 PM MDT





# AGENDA

- **Welcome Introductions:** Saya Haddad, District Project Manager
  - Team Introductions
  - Future Task Force Meetings
    - 11/15/23 Design Task Force #3
- **Bird Rock ES WSM Presentation:** Taal Safdie & Ani Gregory, Safdie Rabines Architects
  - Modernization Scope
  - Existing Conditions
  - Goals
  - Task Force #1 Feedback
  - Concept Sketches
  - Q & A

# MODERNIZATION SCOPE RECAP

- MEET CAMPUS ENROLLMENT NEEDS
- MODERNIZATION
- CODE COMPLIANCE
- SITE REPAIR
- SECURITY
- SPECIAL INITIATIVES













# TASK FORCE #1 GOALS

1. Move secure entrance and administration function closer to the public right of way
2. Maintain campus security that is welcoming to students upon arrival
3. Create learning spaces that promote collaboration, creativity and growth
4. Modernize buildings
5. Remove aging portables
6. Improve technology and security infrastructure
7. Meet campus enrollment needs
8. Consolidate UTK and Kinder Classrooms in one area
9. Enhance parking
10. Improve connectivity throughout campus
11. Minimize unusable and hidden areas on campus allowing for clear sightlines





# DESIGN TASK FORCE MTG #1

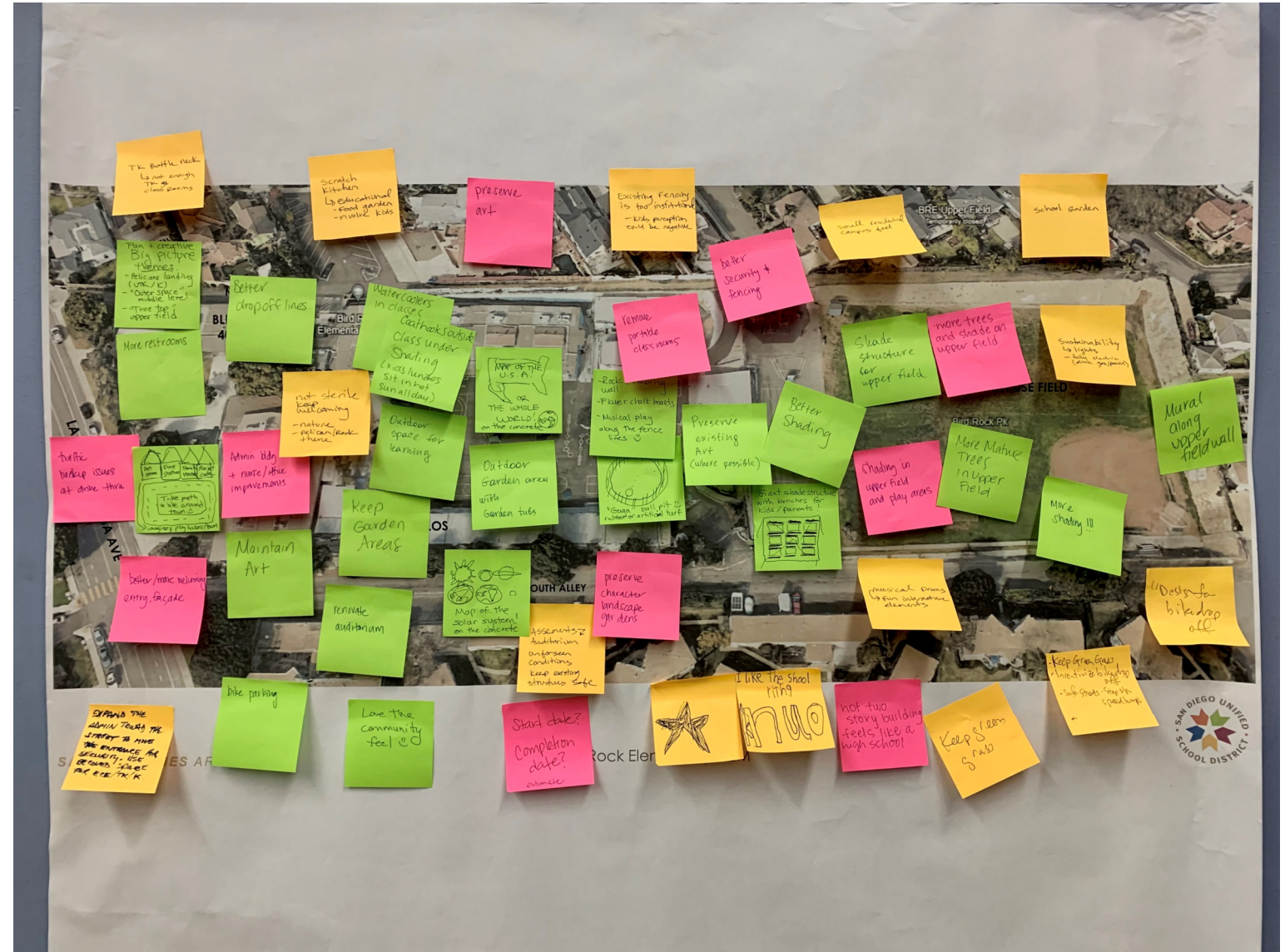



# COMMUNITY FEEDBACK

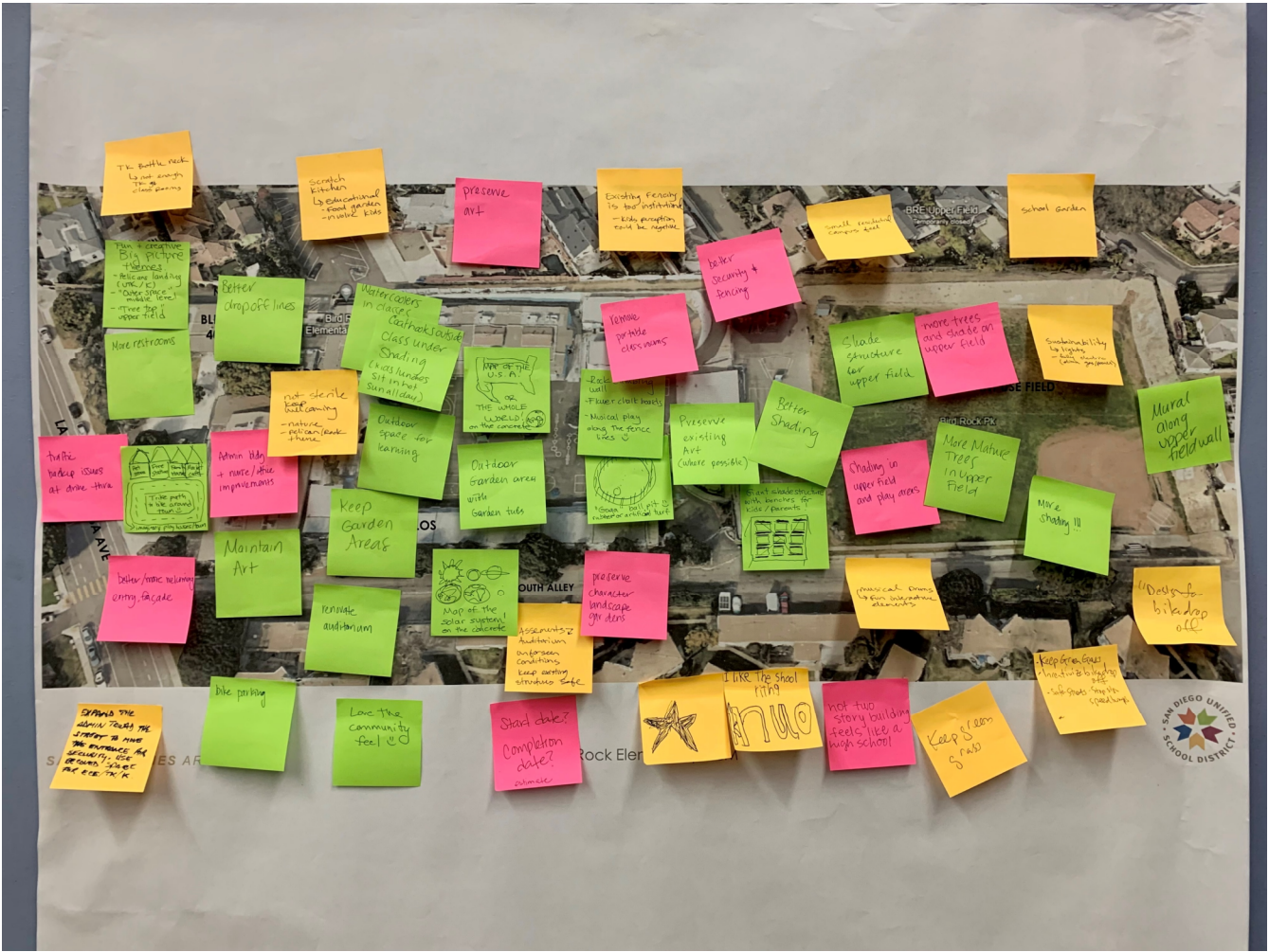

1. More restrooms
2. Better/more welcoming entry façade
3. Admin bldg and nurse/office improvements
4. Expand admin to the front street to move entrance for security
5. Use old Admin space for UTK/Kindergraten
6. Better Drop off lines
7. Coat hooks outside classroom under shading
8. Maintain Art
9. Preserve existing art where possible
10. Keep garden areas
11. Keep green grass

1. Preserve character of landscape gardens
2. Renovate auditorium
3. Map of solar system on concrete
4. Map of USA or entire world on concrete
5. Imaginary play houses/town to bike around
6. Goga ball pit (rubber)
7. Rock wall
8. Musical play along fence lines
9. Musical drums and fun interactive elements
10. Flower chalk boards
11. Outdoor space for learning
12. Shade structure at upper field
13. More trees and shade on upper field
14. More mature trees in upper field
15. More Shading
16. Kinder needs more swings and monkey bars
17. Better security and fencing
18. Eliminate soft spots in fencing for student safety
19. Remove portable classrooms
20. Sustainability (lighting, solar panels)
21. Maintain residential feel of campus
22. Add bike parking
23. Design for bike drop off
24. Safe streets- add speed bumps
25. Start date? Completion date?
26. Traffic, back up issues and drive thru
27. Existing fencing is too institutional
28. Giant shade structure with benches for kids/parents
29. Maintain storage for parent group
30. Mural along upper field wall
31. Outdoor garden area with garden tubs
32. Not sterile, fun pelican/nature theme
33. More playgrounds space, maximize bldg envelope
34. Love community feel



1. More welcoming entry façade
2. Preserve existing art where possible
3. Maintain residential feel of campus
4. Not sterile, fun pelican/nature theme
5. Love community feel





1. Keep garden areas
2. Keep green grass
3. Preserve character of landscape gardens
4. Explore additional shade opportunities
5. More shade on upper field
6. Mural along upper field wall



1. Map of solar system on concrete
2. Map of USA or entire world on concrete
3. Imaginary playhouses/town to bike around
4. Goga ball pit (rubber)
5. Rock climbing wall
6. Musical play along fence lines
7. Musical drums and fun interactive elements
8. Kinder needs more swings and monkey bars
9. More ball courts & tether ball

Franklin Elementary School- "Ball Hill" coming 2024

SAFDIE RABINES ARCHITECTS

Bird Rock Elementary WSM







1. Better security and fencing
2. Eliminate soft spots in fencing for student safety
3. Add bike parking
4. Design for bike drop off
5. Teacher/staff and visitor parking



# GOALS





ADMIN



# WELCOMING ENTRANCE

- ADMIN ENTRANCE VISABLE FROM STREET
- SINGLE POINT OF ENTRY FOR SECURITY
- BUILDING REPLACES PERIMETER FENCING





# WELCOMING ENTRANCE

SAFDIE RABINES ARCHITECTS

Bird Rock Elementary WSM







# CAMPUS CONNECTIVITY

SAFDIE RABINES ARCHITECTS

Bird Rock Elementary WSM

- CLEAR SIGHT LINES
- INTUITIVE CIRCULATION
- CLEAR HEIRACHY OF SPACES







# CAMPUS CONNECTIVITY

SAFDIE RABINES ARCHITECTS

Bird Rock Elementary WSM







# CONSOLIDATE UTK/KINDERGARTEN

**SAFDIE RABINES ARCHITECTS**

Bird Rock Elementary WSM

- UNIFY UTK/KINDER STUDENTS IN ONE AREA
- SEPERATE PICK UP/DROP OFF
- DEDICATED/SECURE PLAY YARDS
- CLOSE TO ADMIN
- UNIQUE SCALE AND CHARACTER







# CONSOLIDATE UTK/KINDERGARTEN

SAFDIE RABINES ARCHITECTS

Bird Rock Elementary WSM







# TAKE ADVANTAGE OF OUR CLIMATE

- INDOOR/OUTDOOR LEARNING SPACES
- MAXIMIZE OUTDOOR PLAYING AREAS





# INDOOR/OUTDOOR CLASSROOMS

SAFDIE RABINES ARCHITECTS

Bird Rock Elementary WSM





# CONCEPT SKETCHES



- DEMO 11 PORTABLES
- DEMO ADMIN BLDG 200
- DEMO KINDER BLDG 400

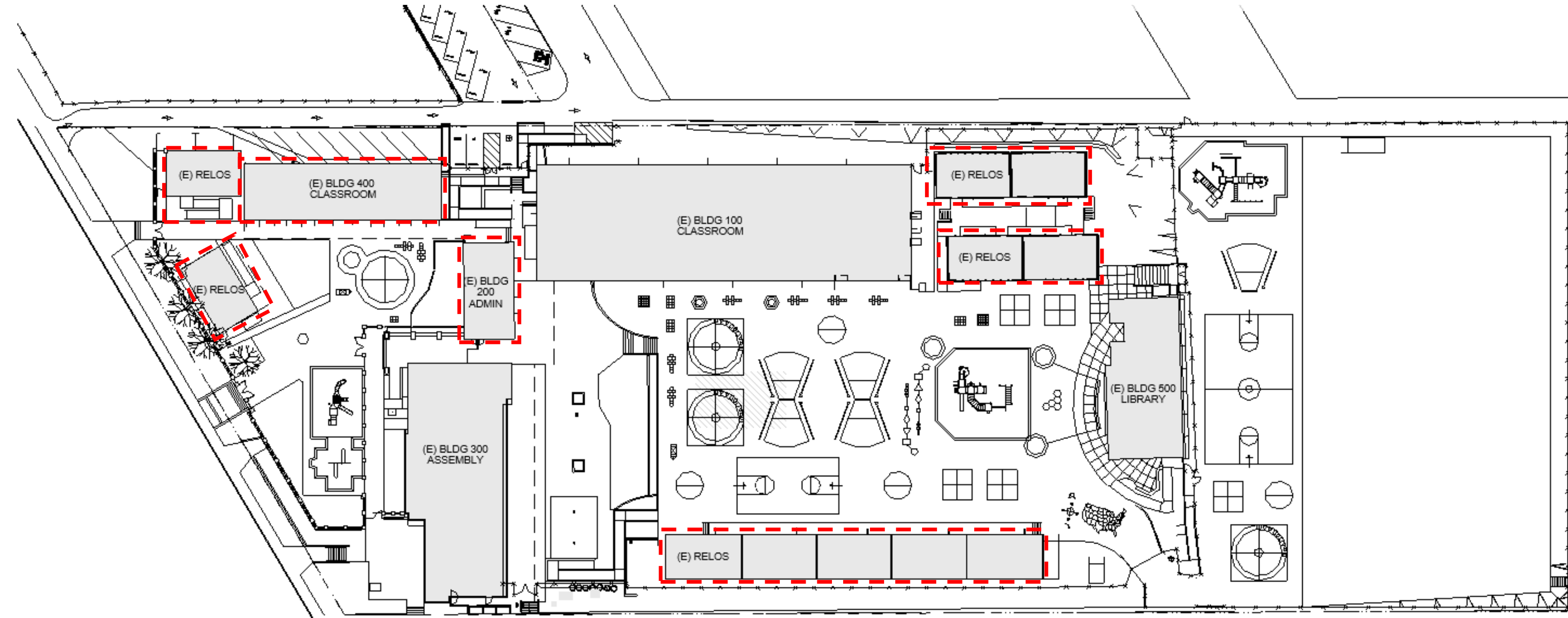

# CONCEPT DEMO PLAN

**NEW 1-STORY BLDG**  
UTK/Kinder Classroom (6)

**BLDG 100**  
Modernize

**BLDG 500**  
Modernize

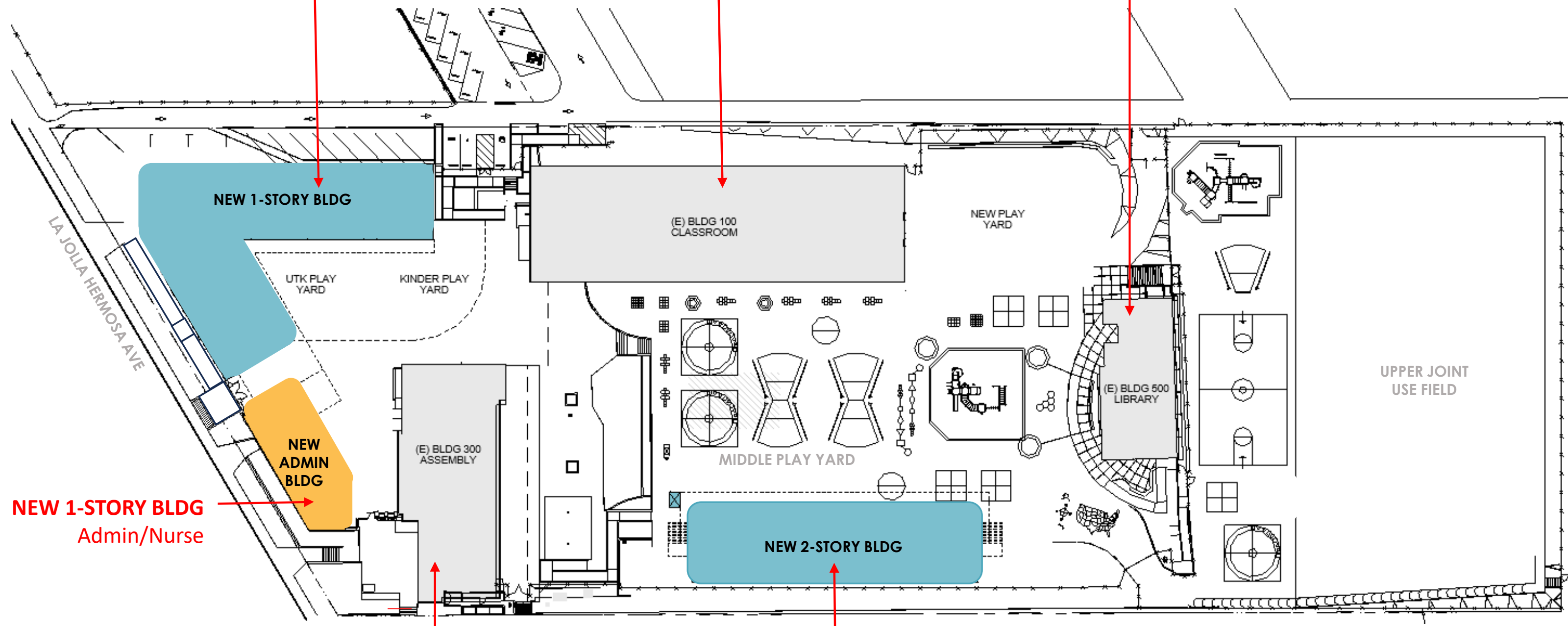

**NEW 1-STORY BLDG**  
Admin/Nurse

**NEW 2-STORY BLDG**  
Classroom (9)

**BLDG 300**  
Modernize

# CONCEPT PLAN

SAFDIE RABINES ARCHITECTS

Bird Rock Elementary WSM





- ADMIN ENTRANCE VISABLE FROM STREET
- SINGLE POINT OF ENTRY FOR SECURITY
- BUILDING REPLACES PERIMETER FENCING

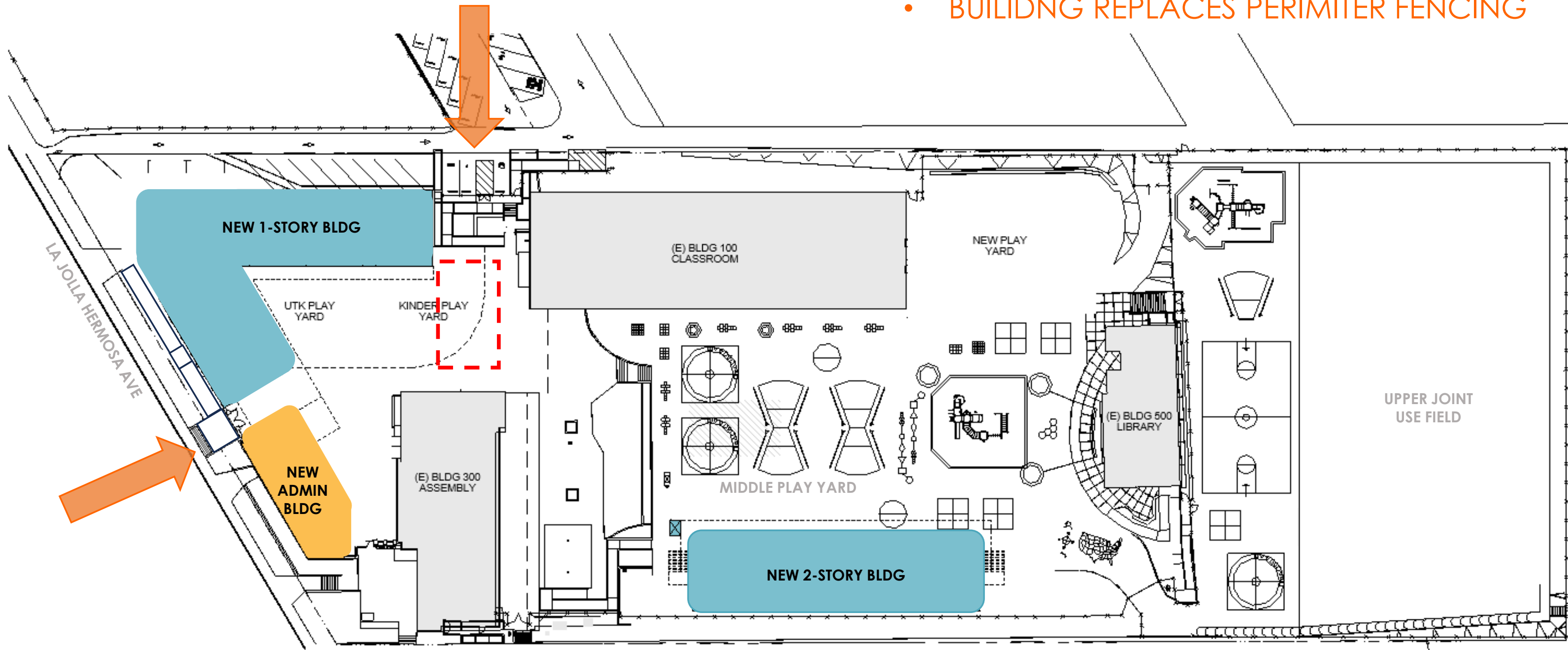

# WELCOMING ENTRANCE



- CLEAR SIGHT LINES
- INTUITIVE CIRCULATION
- CLEAR HEIRACHY OF SPACES

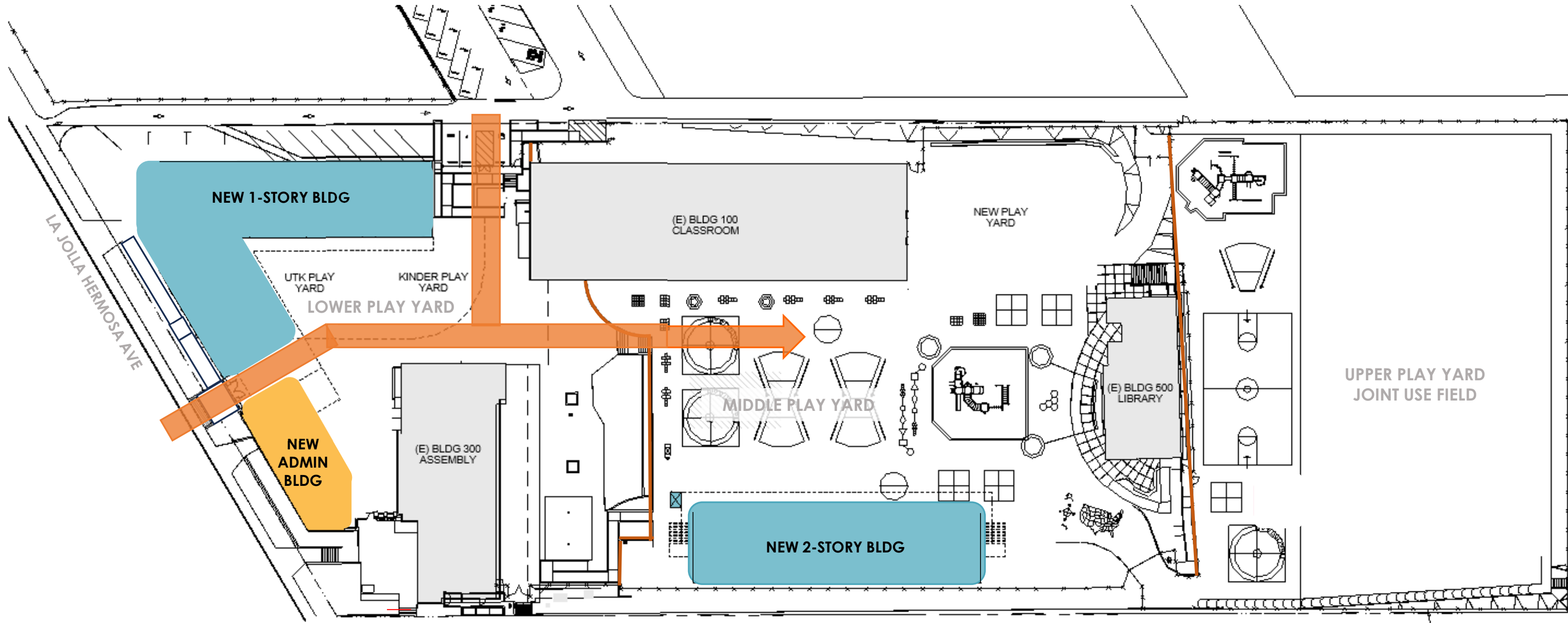

# CAMPUS CONNECTIVITY



- UNIFY UTK/KINDER STUDENTS IN ONE AREA
- SEPERATE PICK UP/DROP OFF
- DEDICATED/SECURE PLAY YARDS
- CLOSE TO ADMIN
- UNIQUE SCALE AND CHARACTER

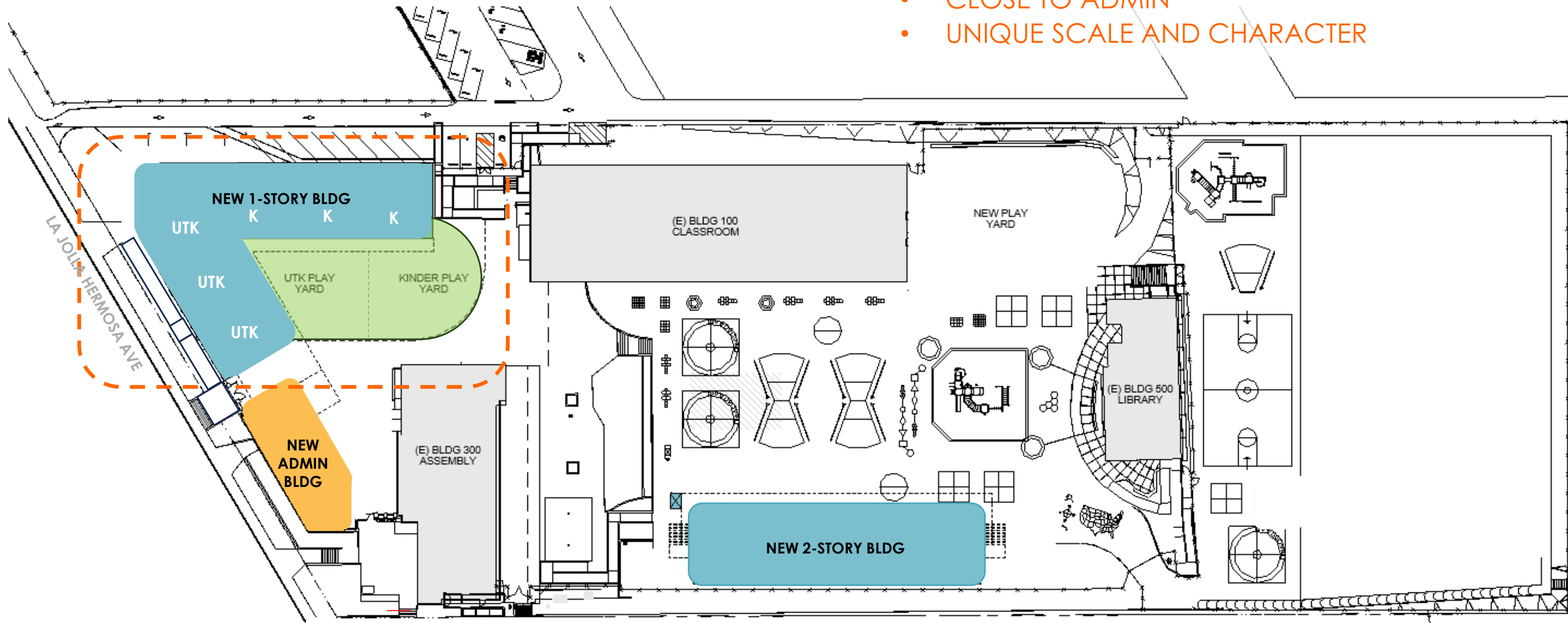

# CONSOLIDATE UTK/KINDERGARTEN





- INDOOR/OUTDOOR LEARNING SPACES
- MAXIMIZE OUTDOOR PLAYING AREAS

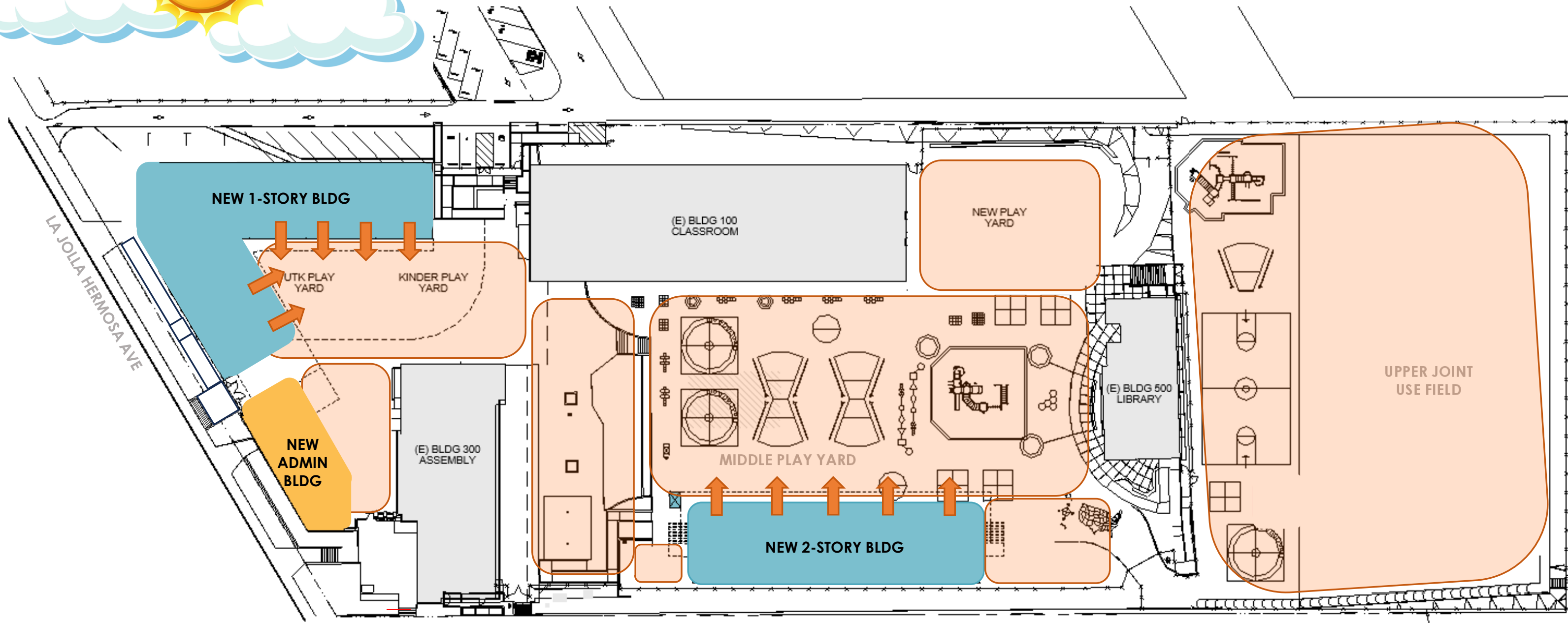

# TAKE ADVANTAGE OF OUR CLIMATE



# COMMUNITY COMMENTS







**FOR UPDATES & UPCOMING**  
**MEETINGS ON THIS TOPIC:**

**Sign In Here**



*Scan the QR Code with the camera  
on your smartphone, then follow  
the link to the sign-in sheet.*

